

# WTO

## *nanoFlex*<sup>®</sup>

新式快換系統  
高精度，體積小巧

最小投資，最大擴充性

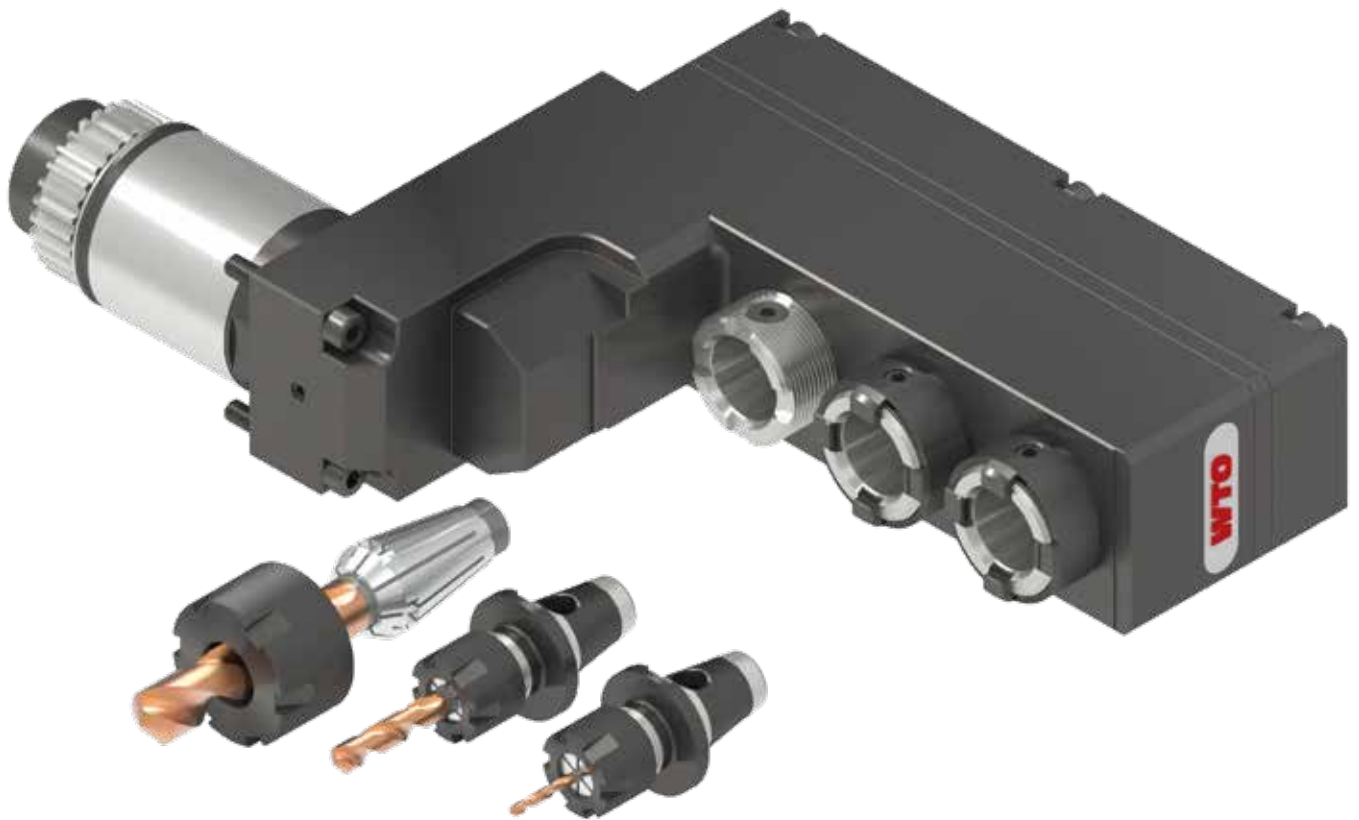

專為走心  
車床設計

# nanoFlex®

完美的結合：  
標準ER筒夾與快換模組合而為一

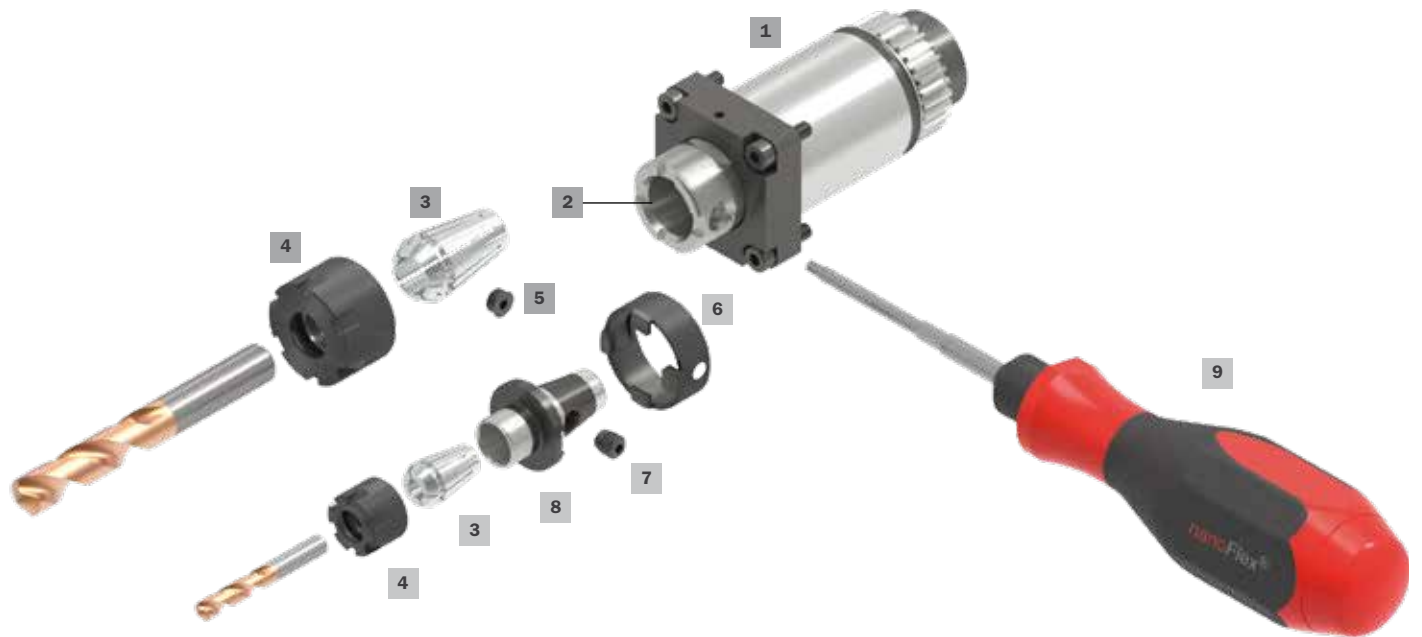

nanoFlex® 快換刀把驅動環安裝後示意圖

- 1 - 快換刀座
- 2 - nanoFlex® 快換刀把介面
- 3 - ER 筒夾
- 4 - 鎖緊螺帽
- 5 - 止付螺絲
- 6 - nanoFlex® 快換刀把驅動環
- 7 - nanoFlex® 鎖固螺絲
- 8 - nanoFlex® 快換刀把
- 9 - nanoFlex® 快換刀把用單手扭力扳手
- 10 - 驅動鍵
- 11 - ER斜錐, ER 筒夾及nanoFlex® 快換刀把共用



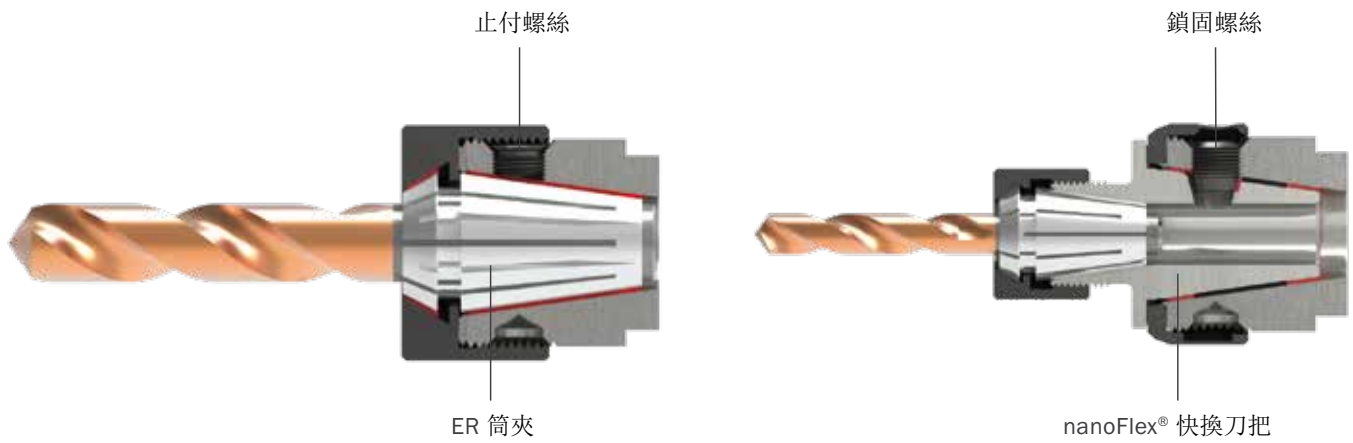

使用ER 筒夾時

使用nanoFlex® 快換刀把時



當使用快換刀把時...

使用前準備



安裝快換刀把與刀具

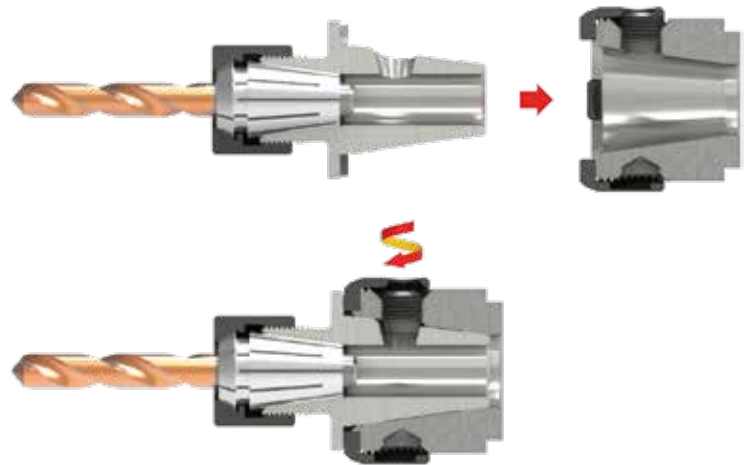

當使用ER 筒夾時...

使用前準備



鎖緊/放鬆螺帽

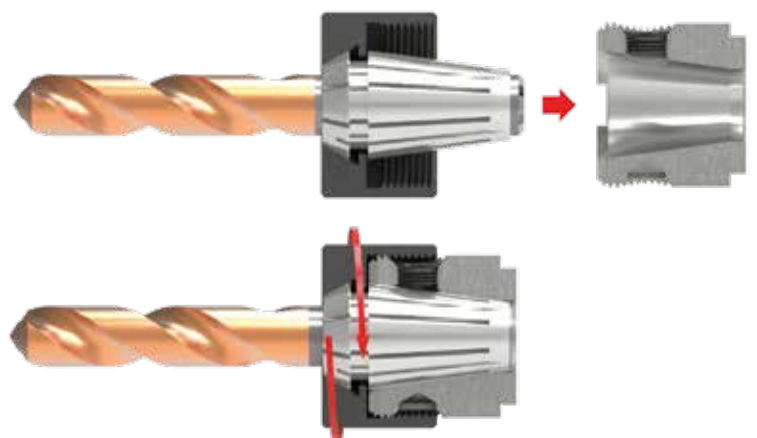



## 直柄轉接刀把

鎖固平面

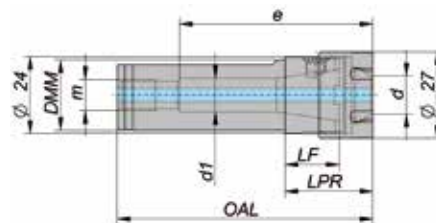
可安裝於搪刀刀位，彈性運用ER 筒夾及nanoFlex® 快換刀把





尺寸	料號	DMM	d min.	d max.	LF	LPR	OAL	d <sub>1</sub>	m	e			
ER-16NF	NF16-SSH-075-A	¾"	0.5	10	17	28.5	78.5	10.5	G1/8"	60.5	NF16-SCN-A	107520005	NF16-SPL-A
ER-16NF	NF16-SSH-022-A	22	0.5	10	17	28.5	80	10.5	G1/8"	60.5	NF16-SCN-A	107520005	NF16-SPL-A
ER-16NF	NF16-SSH-025-A	25	0.5	10	17	28.5	78.5	10.5	G1/8"	60.5	NF16-SCN-A	107520005	NF16-SPL-A

尺寸 mm. 包含螺帽及止付螺絲ER-16Nf

## 筒夾刀把

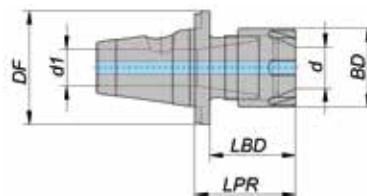
DIN 6499, ISO 15488





尺寸	料號	DF	d min.	d max.	d <sub>1</sub>	BD	LPR	LBD	筒夾尺寸		
ER-16NF	NF16-SAD-ER08-A	23	0.5	5	5.5	12	20.5	17.5	ER 8	200508000	107508005
ER-16NF	NF16-SAD-ER11-A	23	0.5	7	7.5	16	20.5	17.5	ER 11	200511000	107511005

尺寸 mm

## Weldon/Whistle Notch 側固式刀把

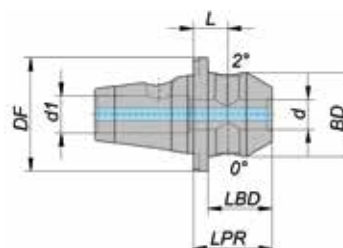
配合DIN 6535-HB 及 -HE 刀柄



尺寸	料號	DF	d	BD	LPR	LBD	L	d <sub>1</sub>		
ER-16NF	NF16-SAD-WW06-A	23	6	17	16	13	7	7.5	12882	26071

尺寸 mm

## 刀具設定機量測用基準刀把

刀把上刻有測量規基準尺寸

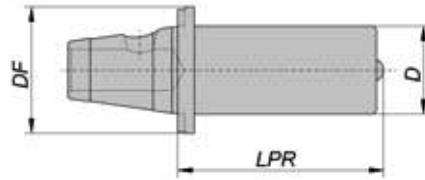





尺寸	料號	DF	D	LPR
ER-16NF	NF16-SMA-A	23	16	37.5

尺寸 mm

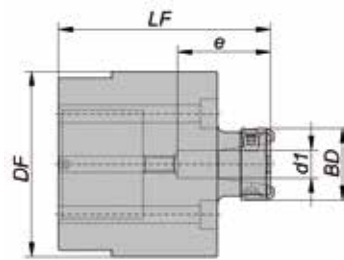
## nanoFlex® 刀具安裝夾具

可於工作檯上輕鬆更換刀具及nanoFlex®刀把預設



尺寸	料號	DF	BD	LF	d <sub>1</sub>	e				
ER-16NF	NF16-SMD-A	70	27	80	10.5	35	NF16-STW-A	NF16-SDR-A	NF16-SCS-A	29205



尺寸 mm

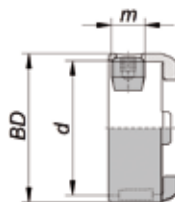

## 驅動環

配合nanoFlex® 快換刀把



尺寸	料號	BD	d	m			
ER-16NF	NF16-SDR-A	27	24	M6x0.5	10IP	NF16-SCS-A	NF16-STW-A

尺寸 mm. 包含鎖固螺絲

## 扭力板手

單手更換nanoFlex® 快換刀把用



注意：  
起子頭可更換

尺寸	料號		Nm	
ER-16NF	NF16-STW-A	10IP	2.5	109330

尺寸 mm

## ERNF 鎖固螺絲

鎖固nanoFlex® 快換刀把用



尺寸	料號		Nm	
ER-16NF	NF16-SCS-A	10IP	2.5	NF16-STW-A

尺寸 mm

## ERNF 鎖緊螺帽

配合nanoFlex® 快換刀把用

DIN 6499, ISO 15488

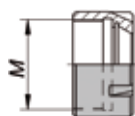



尺寸	料號	M	Nm	
ER-16NF	NF16-SCN-A	M24x1	45	107520005

尺寸 mm

## ERNF 止付螺絲

封閉螺孔用



尺寸	料號		Nm	
ER-16NF	NF16-SPL-A	10IP	2.5	NF16-STW-A

尺寸 mm



WTO  
Werkzeug-  
Einrichtungen GmbH 德國  
Neuer Hohdammweg 1  
77797 Ohlsbach  
德國

WTO Inc. 美國  
13900-F South Lakes Dr.  
Charlotte, NC 28273  
美國

WTO 亞洲  
WTO Precision Tool Holders  
(Shanghai) Co. Ltd.  
Room 109-110, Building 2  
No. 228 Banting Road  
Jiuting Town,  
Songjiang District  
201615 Shanghai  
中國

## 我們的全球合作夥伴。提供充分的技術及服務

澳大利亞  
Dimac Tooling Ltd.  
sales@dimac.com.au

英國  
Cutwel Ltd.  
sales@cutwel.net

韓國  
WTO Office Korea  
is.chon@wto-korea.com

瑞士  
Utilis AG  
info@utilis.com

巴西  
TF2  
tfdois@tfdois.com.br

匈牙利  
Prevotex Hungary Kft.  
info@prevotex.hu

墨西哥  
Workholding Engineering De México  
info@wem.com.mx

斯洛伐克  
ALBA precision s.r.o.  
albabprecision@albabprecision.sk

中國  
Shanghai Gangde  
wtocando@yahoo.com

印度  
Ulhas Patil  
u.patil@wto-asia.com

荷蘭  
Toologic BeNeLux B.V.  
info@toologic-benelux.nl

西班牙  
ITALMATIC, S.A.  
italmatic@italmatic.es

丹麥  
AVN Teknik A/S  
cjo@avn.dk

以色列  
E.Y.A.R. Ltd.  
boris@eyar.co.il

挪威  
Helge Karlsen Verktøy og Maskin AS  
hkvm@hkvm.no

台灣  
Kaiko Co., Ltd.  
info@kaiko.com.tw

芬蘭  
Suomen Terästuonti Oy  
myynti@stt.as

意大利  
Prymark srl  
commerciale@prymark.it

波蘭  
ARCO Andrzej Rudenko  
info@arcotools.pl

土耳其  
MYK CNC MAKINA SAN. VE  
huseyin.tatlidil@mykcnc.com.tr

法國，東部  
Christophe Archambault  
alm@wto.de

日本  
NK Works Co. Ltd.  
k\_samba@nk-works.co.jp

羅馬尼亞  
SC Elif Trading SRL  
bulent.ozkan@eliftrading.com

捷克  
ALBA precision, spol. s.r.o.  
info@albabprecision.cz

法國，西部  
Christophe Archambault  
car@wto.de

加拿大  
Mittmann Industrial Inc.  
info@mittmann.com

瑞典  
Bonhron & Ewing AB  
info@bonhron-ewing.se

烏克蘭  
„LLC“ SPA Stankopromimport  
info@phoenix-ua.com